

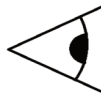

# ARCONE®



(EU) 2016/425  
 CE EN 166, EN 175,  
 EN 379  
 ANSI Z87  
 CAN/CSA Z94.3



EN 379: A3			

ARCONE® is a Division of A.C.E. International Company  
 85 Independence Drive, Taunton, MA 02780, USA  
 TEL: +1 (508) 884-9600 • TOLL FREE: +1 (800) 223-4685

or

Please visit our website: [www.arc1weldsafe.com](http://www.arc1weldsafe.com)  
[eu.arc1weldsafe.com](http://eu.arc1weldsafe.com)



 **Warnings**

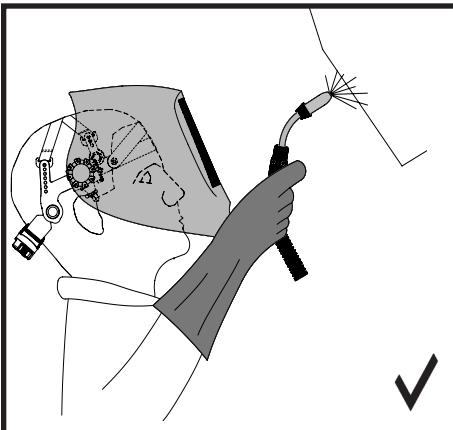
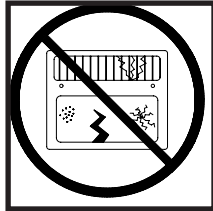
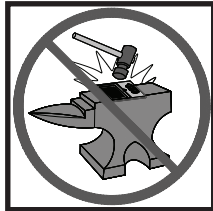
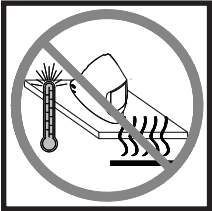
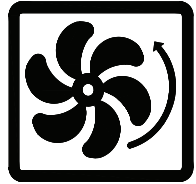
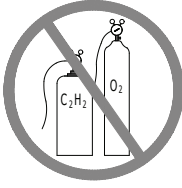
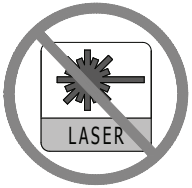
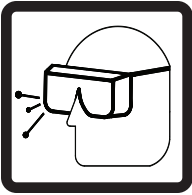
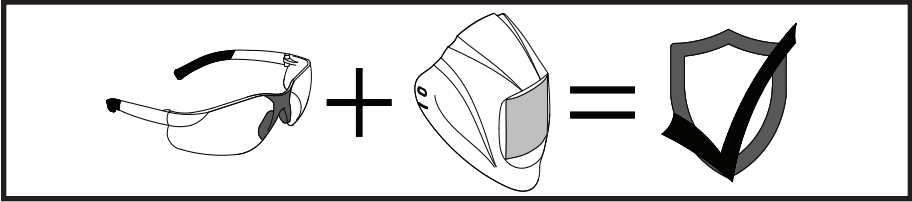

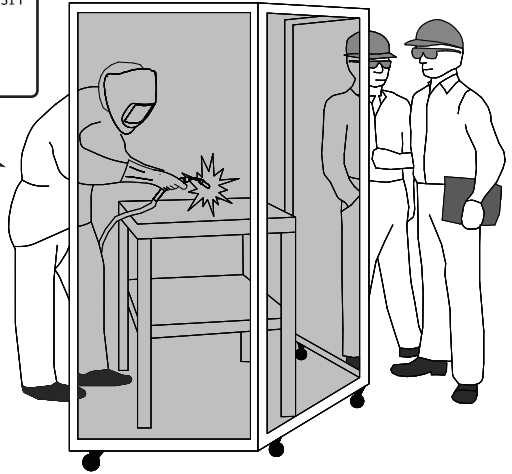
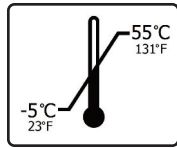

NFPA 51B  
ANSI Z49.1  
ISO 11611:2015

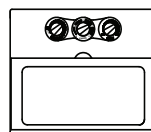
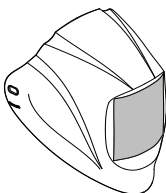
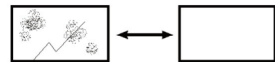
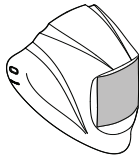
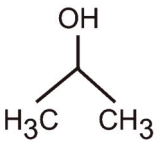
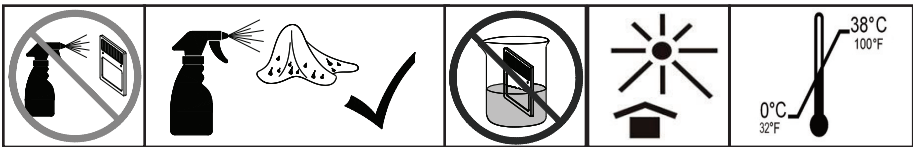
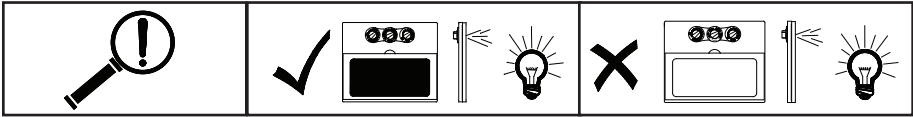
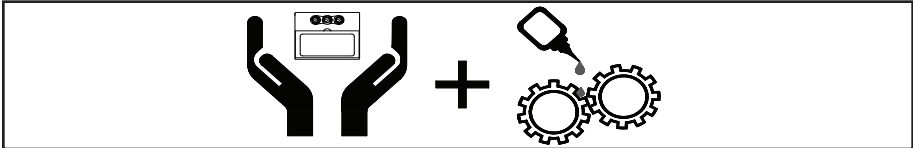

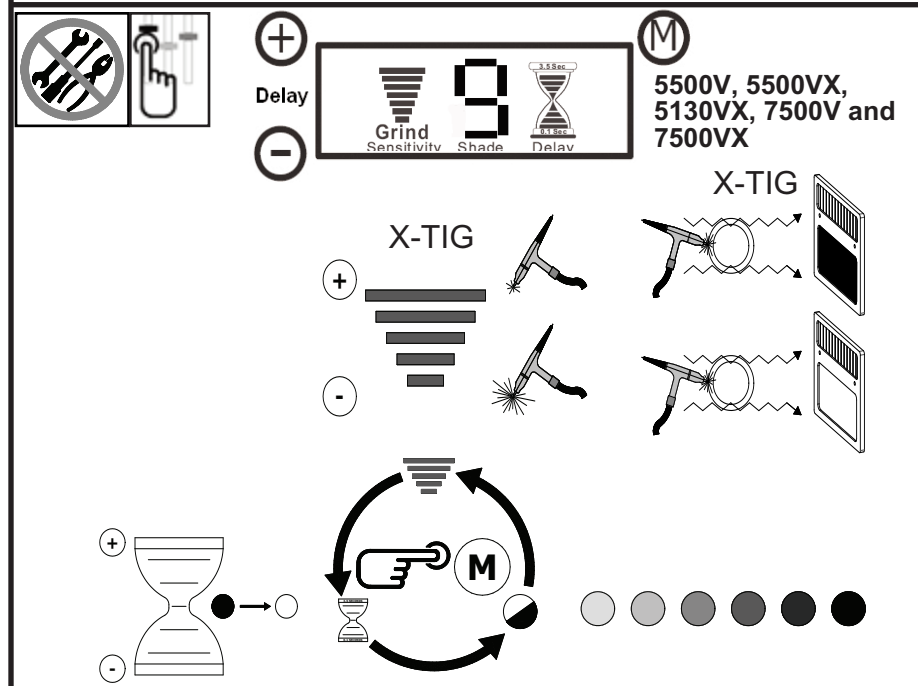
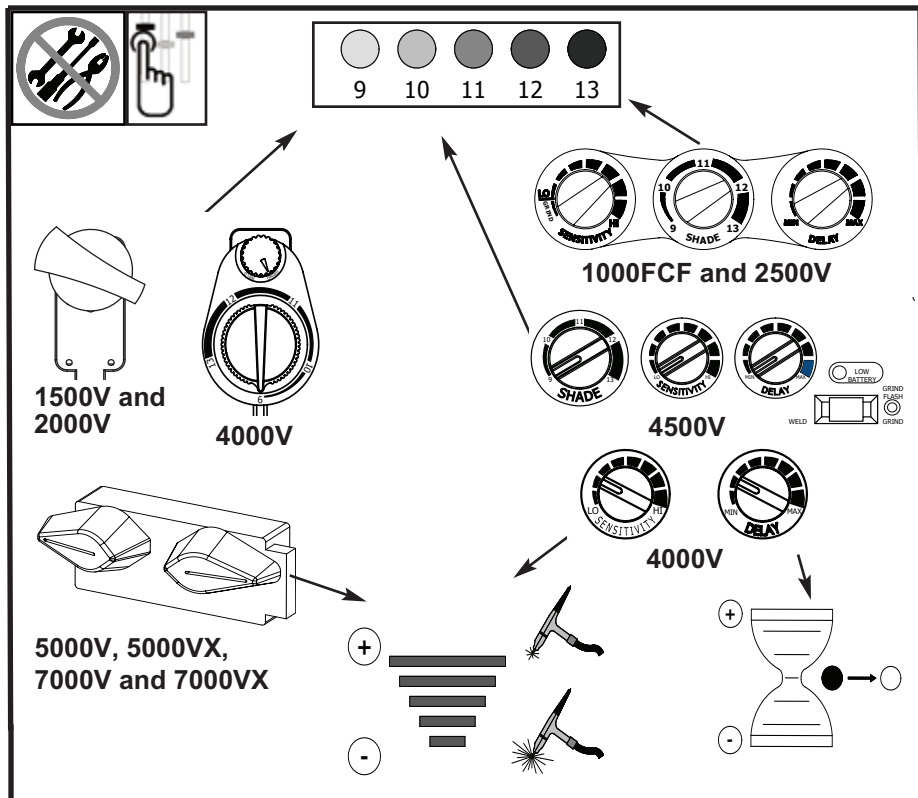

# Shade Selection Guide from EN 379 Table A.3

Table A.3 – Recommended use of the different shade numbers for arc welding

Process	Current A																																							
	1.5	6	10	15	30	40	60	70	100	125	150	175	200	225	250	300	350	400	450	500	600																			
Covered electrodes					8				9				10				11				12				13				14											
MAG									8				9				10				11				12				13				14							
TIG					8				9				10								12				13															
MIG with heavy metals													9				10				11				12				13											
MIG with light alloys																	10				11				12				13				14							
Air-arc gouging													10				11				12				13				14				15							
Plasma jet cutting									9				10								12				13															
Micro-plasma arc welding	4		5		6		7		8		9		10		11		2																							
	1.5	6	10	15	30	40	60	70	100	125	150	175	200	225	250	300	350	400	450	500	600																			

NOTE The term "heavy metals" applies to steels, alloy steels, copper and its alloys, etc.



## Head Gear Adjustment

Height Adjustment: Push Pin into Hole for Sightline



Ratchet Adjustment: Push and Turn for Circumference

Angle Adjustment: Place Pin in Helmet Hole

Horizontal Adjustment: Loosen Knob and Slide Front and Back

# CARRERA™ ArcOne®

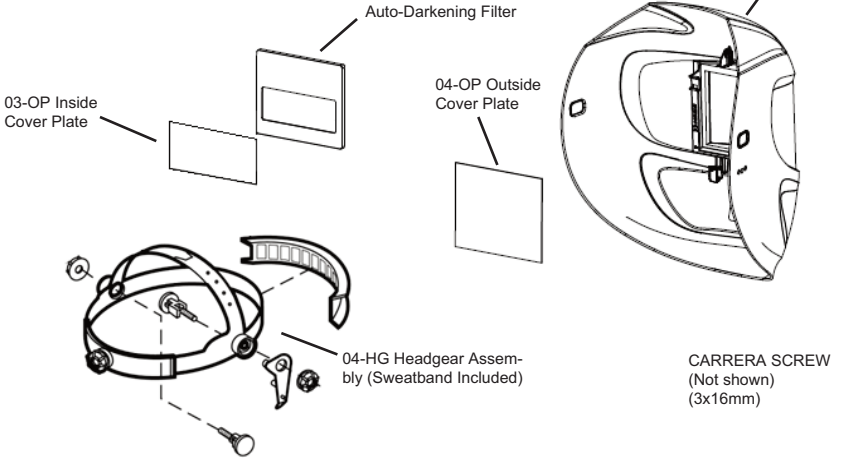

# VISION®

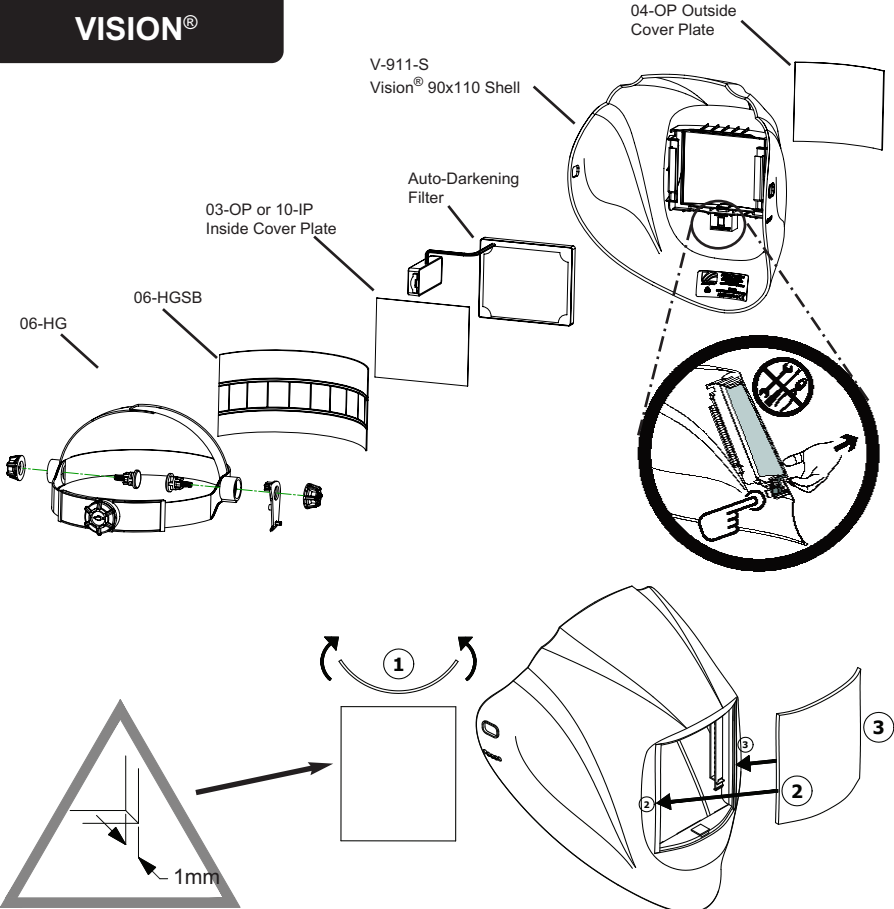

# PYTHON®

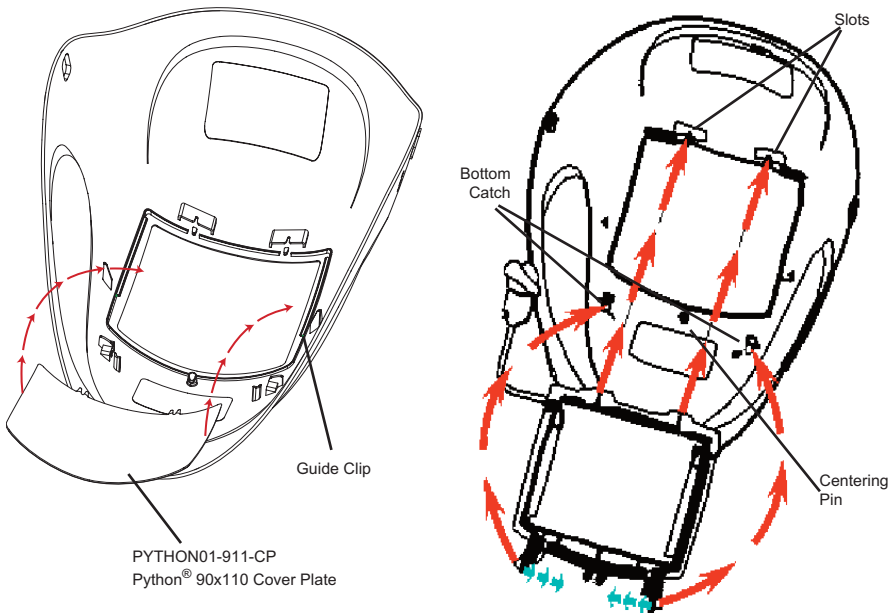
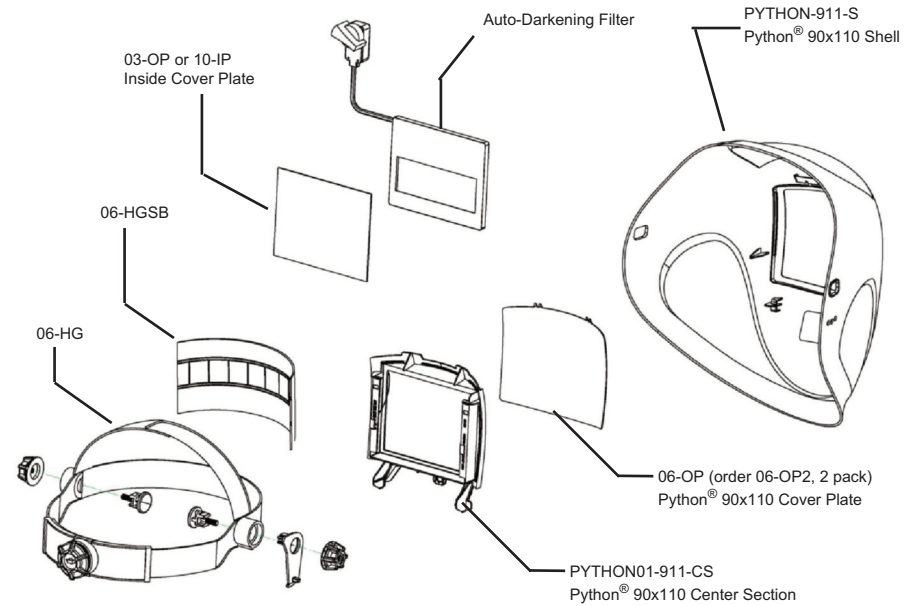

**Note:** Cover Plates are Optical Class 1 and are suitable for regular use. Change cover plates when they become distorted, cracked, scratched, or pitted. Change cover plates if they cannot be cleaned. Do not use damaged cover plates as damaged plates may result in injury.

# Significance of Markings:

EN 379:



Z87 = ANSI Standard for Eye and Face Protectors

W = Welding Filter

CAN/CSA Z94.3 = CSA Standard for Eye and Face Protectors

CE = European Mark

4 = Light Shade Number

9-13 = Dark Shade Range

AR = ArcOne's Manufacturer's Mark

1 = Optical Class

2= Diffusion of Light Class

1= Variation in Luminous Transmittance Class

3= Angle Dependency Class

EN 379 = CE Welding Filter Standard

EN 175:



AS/NZS 1337 = Australian Standard for Eye Protectors

Z87+ = ANSI High Mass Impact

CAN/CSA Z94.3 = CSA Standard

EN 175 = CE Welding Helmet Standard

-B = Impact Class (Medium Energy)\*

-F = Impact Class (Low Energy) - Python only

## Product Certification Bodies

**1000FCF, 1500V, 2000F (AM-10),**

**2000V, 2500V, 4000V, 4500V, 5130VX**

**7000V, 7000VX, 7500V, 7500VX:**

DIN CERTCO GmbH (0196)

Alboinstrasse 56

12103 Berlin, Germany

**2000F(11):**

CERTOTTOCA Scarl (0530)

Zona Industriale Villanova

I-31013 Longarone BL - Italy

**5000V, 5000VX, 5500V, 5500VX:**

ECS GmbH (1883)

Obere BahnstraBe 25

73431 Aelen - Germany

**Carrera ArcOne, Python, Vision:**

INSPEC International (0194)

56 Leslie Hough Way

Salford Greater Manchester

M6 6AJ, England

EN 166:



AR = Manufacturer's Mark

1 = Optical Class

B= Impact Class (Medium Energy)

F= Impact Class (Low Energy)

06-OP only

CE = CE Standard

ADF	Rear Cover Plate
1000FCF	03-OP
1500V	03-OP
2000F (AM-10)	04-OP
2000F (11)	04-OP
2000V	03-OP
2500V	03-OP
4000V	03-OP
4500V	03-OP
5000V/VX	03-OP
5130VX	03-OP
5500V/VX	03-OP
7000V/VX	10-IP
7500V/VX	10-IP

**\* NOTE:** If protection against high speed particles is required at extreme temperatures, only use a protector where the Impact Class is followed by a "T", e.g. -BT. Otherwise, use at room temperature.

